

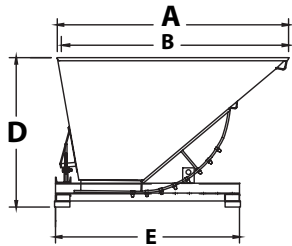

# LIGHT-DUTY SELF-DUMPING HOPPERS

## 1- 1/2 TO 5 CUBIC YARD HOPPERS

Wastequip light-duty self-dumping hoppers are ideal for lightweight materials or bulky materials that take up more space than weight. These hoppers are a great fit for lightweight recycling, plant maintenance, wood scraps of all types (sawdust, pallets, cabinets, paper mills) as well as cardboard, plastic and metal shavings. Hoppers are constructed of 12 gauge steel with fully welded rocker stop supports and formed base.



1/2, 1, 1-1/2 cubic yard hoppers

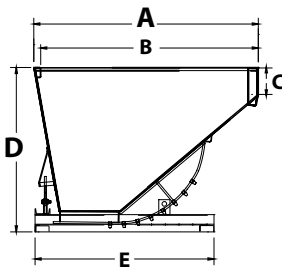

2, 2-1/2 cubic yard hoppers

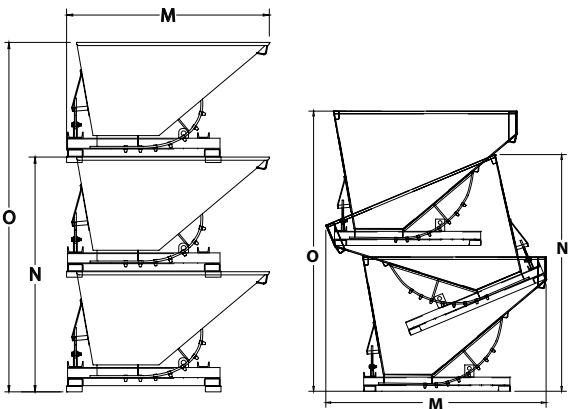
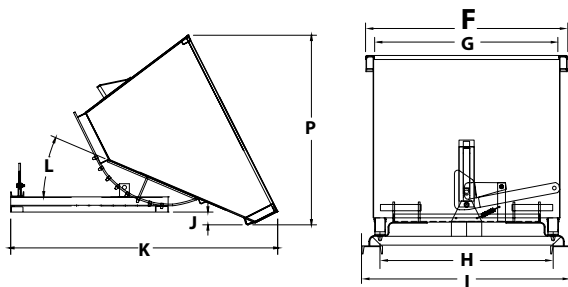

## FEATURES

- 12 gauge steel body
- 1" round rocker stops
- Designed for 1,500 to 2,000 lb. capacities

Distributed By:



[www.onesourcerental.com](http://www.onesourcerental.com)

	LH-50	LH-100	LH-150	LH-200	LH-250
<b>Vol. capacity (cu. yds.)</b>	1/2	1	1-1/2	2	2-1/2
<b>Weight capacity (lbs.)</b>	1,500	1,500	2,000	2,000	2,000
<b>Shipping weight (lbs.)</b>	369	417	472	509	570
<b>A - Outside Dimension</b>	49-1/4"	60-1/2"	60-1/2"	60-1/2"	60-1/2"
<b>B</b>	47-1/2"	58-1/2"	58-1/2"	58-3/8"	58-3/8"
<b>C</b>	n/a	n/a	n/a	7-1/4"	7-1/4"
<b>D - Outside Dimension</b>	30-3/4"	39"	37-1/2"	44"	44"
<b>E</b>	39-1/4"	48"	48"	48"	48"
<b>F - Outside Dimension</b>	39-3/4"	39-3/4"	58-1/4"	58-1/4"	72-1/2"
<b>G</b>	36-1/2"	36-1/2"	54-3/4"	54-3/4"	54-3/4"
<b>H</b>	36-1/2"	38"	38"	38"	38"
<b>I</b>	40-1/2"	40-1/2"	38-5/8"	38-5/8"	38-5/8"
<b>J</b>	8-3/8"	3-1/2"	3-1/2"	3-7/8"	3-7/8"
<b>K</b>	59"	76"	76"	81-1/2"	81-1/2"
<b>L</b>	29°	21.5°	21.5°	25°	25°
<b>M</b>	55"	66"	67"	75"	75"
<b>N</b>	59-1/2"	77"	70"	78"	78"
<b>O</b>	89"	114"	77-1/2"	93-1/2"	93-1/2"
<b>P</b>	47"	54"	57"	58"	58"

NOTE: The LH-50 and LH-100 stack. The LH-150, LH-200 and LH-250 nest.

# HOPPER OPTIONS

## CASTERS

Semi-steel, phenolic, rubber mold-on or polyurethane (two swivel and two rigid) casters available.



Semi-steel



Phenolic



Rubber Mold-on



Polyurethane

OPTION	TYPE	CAPACITY	WHEEL	BEARING	HEIGHT	WEIGHT
<b>NO. 1</b>	4" Semi-Steel	3200 lbs.	4" x 1-1/2"	Roller	5-3/4"	28 lbs.
<b>NO. 2</b>	6" Semi-Steel	3400 lbs.	6" x 2"	Roller	7-1/2"	46 lbs.
<b>NO. 3</b>	8" Semi-Steel	4200 lbs.	8" x 2"	Roller	10"	64 lbs.
<b>NO. 4</b>	6" Phenolic	3600 lbs.	6" x 2"	Self Lubricating	7-1/2"	44 lbs.
<b>NO. 5</b>	6" Rubber - Mold-On	1640 lbs.	6" x 2"	Roller	7-1/2"	42 lbs.
<b>NO. 6</b>	8" Rubber - Mold-On	2000 lbs.	8" x 2"	Roller	10"	60 lbs.
<b>NO. 7A</b>	6" Polyurethane	3600 lbs.	6" x 2"	Roller	7-1/4"	36 lbs.
<b>NO. 7B</b>	8" Polyurethane	3600 lbs.	8" x 2"	Roller	9-1/2"	38 lbs.

Casters not available for models H-300, H-300LP, H350LP, H400 or H500.

## HOPPER COVERS

Hopper covers offer debris containment and security. Constructed of carbon steel, these covers feature an X-crimp design for water drainage.

OPTION	HOPPER SIZE	TYPE A	TYPE B	TYPE C
<b>NO. 16</b>	1/2 yd.	50 lbs.	56 lbs.	54 lbs.
<b>NO. 17</b>	3/4 and 1 yd.	59 lbs.	64 lbs.	62 lbs.
<b>NO. 18</b>	1-1/2 yd.	80 lbs.	86 lbs.	85 lbs.
<b>NO. 19</b>	2 yd.	102 lbs.	110 lbs.	108 lbs.
<b>NO. 20</b>	2-1/2 yd.	109 lbs.	117 lbs.	114 lbs.

Covers are a non-inventory item. Please allow additional manufacturing time.

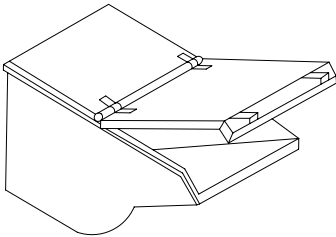

**TYPE A**

Weld on back with single center hinge

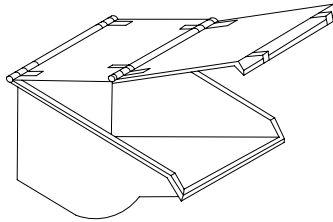

**TYPE B**

Double hinged - Back and center

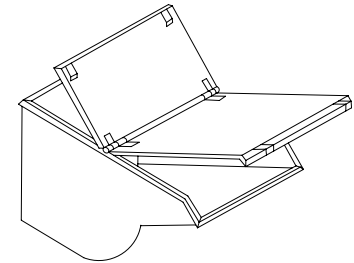

**TYPE C**

Single hinged center

## OPTIONS

- Hopper retaining chain and bracket **1**
- Hopper floor lock **2**
- Three-way entry (1/4 to 3 cubic yard sizes only) **3**
- Platform legs **4**
- Pull bracket with 10' nylon rope **5**
- Drain plug
- Drain sump
- Crane pick-up eyes
- Available in multiple paint options

